

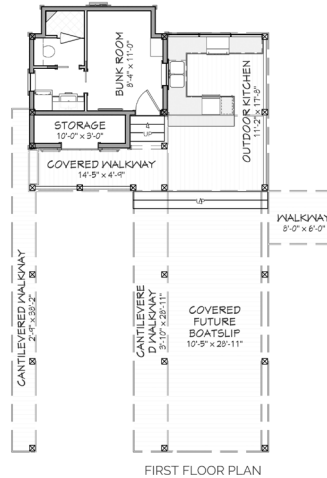

STUDIO

D E S C R I P T I O N

THIS BOATHOUSE IS PERFECT IF YOU LIKE THINGS TO BE COMPACT AND SPACE-EFFICIENT! AND WHAT BETTER PLACE TO HAVE A KITCHEN THAN THE OUTDOORS? THIS BOATHOUSE ALSO HAS THE OPPORTUNITY TO EXPAND TO A TWO-SLIP. THIS BOATHOUSE MAY BE COMPACT, BUT IT STILL HAS ROOM TO ENLARGE.



A R E A C A L C U L A T I O N S

FIRST FLOOR CONDITIONED
175 SQ FT
 TOTAL CONDITIONED
175 SQ FT
 FIRST FLOOR UNDER ROOF
1368 SQ FT
 TOTAL UNDER ROOF
1368 SQ FT

H I G H L I G H T S

- ONE-STORY ▪ BOATHOUSE
- POTENTIAL TWO-SLIP ▪ COMPACT
- OUTDOOR KITCHEN ▪ 1 BATHROOM
- ONE-SLIP ▪ DECK ▪ 1 BUNKROOM

DECATUR
BOATHOUSE

THIS IS PROPERTY OF LAKE + LAND STUDIO, LLC. THIS IS NOT A CONSTRUCTION DOCUMENT AND MAY NOT BE USED OR REPRODUCED WITHOUT THE PERMISSION OF LAKE + LAND STUDIO, LLC.

LAKE + LAND STUDIO, LLC
 HATTIESBURG, MS 39402
 601.336.8114
 WWW.LAKEANDLANDSTUDIO.COM